



# ARTWORK FOR APPROVAL

**IMPORTANT:** This drawing is for approximate print positional purposes only. It is not intended to be an exact scale or detailed representation of the product. Colour proofs are to be used as a guide only and not a true representation of true product or print colour. If item colours are important, order a sample from our current shipment.

Order #  
Proof #1  
Date 00/00/00

**Product Code** : LL8211  
**Description** : Style Gift Set - Bling Pen and Swivel Flash Drive  
**Item Colour/s** : Silver  
**Quantity** :  
**Decoration Type** : Digital Direct (Pen & Flash Drive) + Pad (Box)  
**Print Colour**



**DIGITAL DIRECT:** This item is digitally printed in CMYK. If pantone colour matching is important we require you to provide specific PMS colours, and we will produce closest CMYK colour match possible (to CP equivalent of coated pantone colours - perfect colour match not guaranteed). Vector art is required for colour matching. We are unable to edit colours in rasterized images. Print colours may be altered in appearance if placed on a strong colour background.

## BELOW IS 70% OF ACTUAL SIZE

Metallic Silver or Gold print recommended



Maximum print area: 60mmL x 60mmH  
Actual print size:

Example of the product inside the black gift box

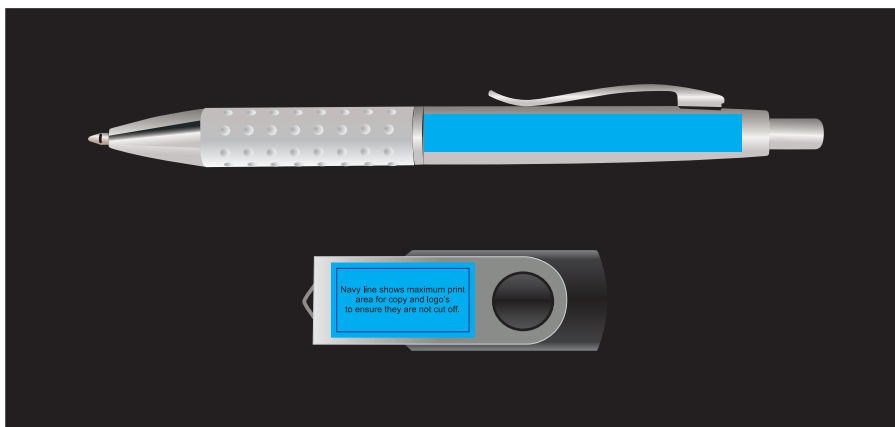

**PLEASE SEE NEXT PAGE...**

### INTERNAL USE ONLY

INT:

QC Code:	New Pte # _____	Info:	Q: _____	Ctns: _____	Wt(kg): _____
PP:	Prt Int: _____	Prep:	S: _____	D: _____	
Rpt Ord:	Rpt Pte # _____	Cat:	E: _____	Ctns: _____	Wt(kg): _____
Split: Y/N	Mach: _____	U/P Int: _____	R/P Int: _____	R: _____	D: _____
Courier:					Total Wt(kg): _____



Maximum print area: 27mmL x 14mmH  
Actual print size:

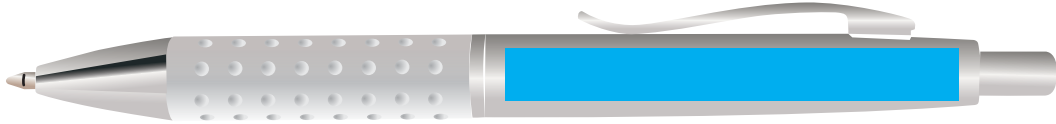

Maximum print area: 60mmL x 7mmH  
Actual print size:



Maximum print area: 60mmL x 60mmH  
Actual print size:

### Example of the product inside the black gift box

